

# CEC Changeover switch compact base mounting

3P - 3P+N

Size 00

A 63|80|100|125

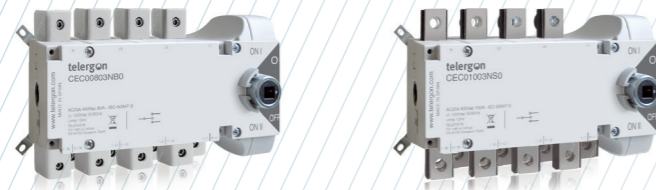
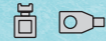

## Accessories



» Direct handle  
CODE D5LSI01



» Auxiliary contacts AU  
1NO+1NC CODE DCEAUB1  
Ie = 0,1 A (resistive) at 125 Vac.



» External handle included shaft \*(e1)  
IP65  
CODE DCELAB1



» Phase barrier  
3P CODE DCECUB1  
4P CODE DCECUB2  
(1 kit for input or output)

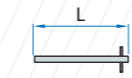

» Shafts  
Standard shaft included \*(e1)

L (mm)	P (mm)	CODE
137	15... 105	

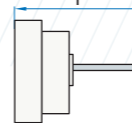

Shaft extensions		
Type 1		
L (mm)	P (mm)	CODE
250	85... 278	DS-EP04
Type 2		
L (mm)	P (mm)	CODE
387	85... 415	DS-EP05

## Dimensions (mm)

Door drilling for external handle

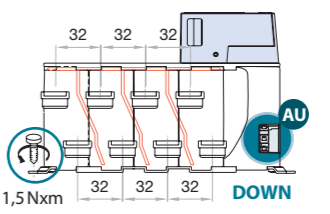
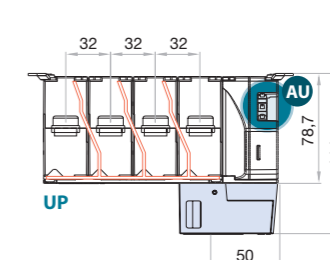
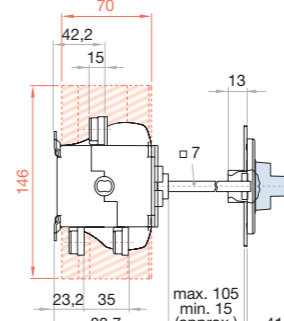
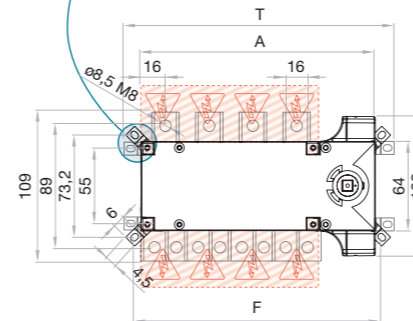
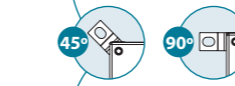
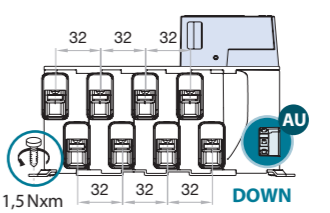
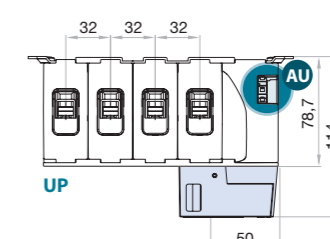
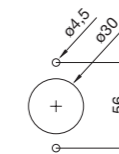
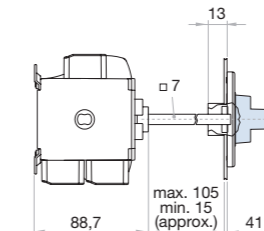
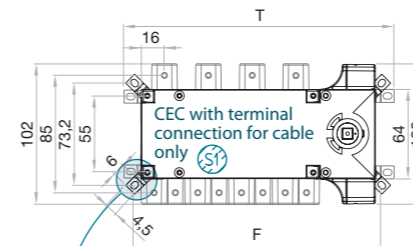

S1 max (Cu) mm <sup>2</sup>	M
63 A	25
80 A	M8 3

S2 max (Cu) mm <sup>2</sup>	H max (Cu) mm	L max (Cu) mm	M
63 A	35	3	16
80 A	3	16	M8 6
100 A	50 <sup>(e5)</sup>	3	19
125 A			

\*(e5) Use phase barriers in order to keep the clearance in air distances.

Patent pending EP18382154

## Technical information



According to IEC 60947-3

		63				80				100				125					
Rated thermal current I <sub>th</sub> in ambient at	40°C	A	63	80	100	125	A	63	80	100	125	A	63	80	100	125			
	50°C	A	63	80	100	125	A	63	80	100	125	A	63	80	100	125			
	60°C	A	63	80	100	125	A	63	80	100	125	A	63	80	100	125			
Rated insulation voltage	U <sub>i</sub>	V	1000	1000	1000	1000	V	1000	1000	1000	1000	V	1000	1000	1000	1000			
Rated impulse withstand voltage	U <sub>imp</sub>	kV	8	8	8	8	kV	8	8	8	8	kV	8	8	8	8			
AC rated operational current <sup>(e1)</sup>	U <sub>e</sub> 400V	AC21A	A	63	80	100	125	AC21A	A	63	80	100	125	AC21A	A	63	80	100	125
		AC22A	A	63	80	100	125	AC22A	A	63	80	100	125	AC22A	A	63	80	100	125
		AC23A	A	63	80	100	125	AC23A	A	63	80	100	125	AC23A	A	63	80	100	125
Rated breaking capacity	400 V	63A-100A cosφ=0,45	A	504	640	800	1000	63A-100A cosφ=0,45	A	504	640	800	1000	63A-100A cosφ=0,45	A	504	640	800	1000
Rated making capacity		125A cosφ=0,35	A	630	800	1000	1250	125A cosφ=0,35	A	630	800	1000	1250	125A cosφ=0,35	A	630	800	1000	1250

\*(e1) Other voltages and / or utilization categories. Please consult  
\*(e2) Without limiting protective device (short-circuit maintained 50... 100 ms.)  
\*(e3) Please consult us for more operations

		63				80				100				125			
Short-circuit behaviour		Rated short-circuit making capacity <sup>(e2)</sup>		I <sub>cm</sub>	kA	1,5	1,5	2,9	2,9	Rated short-time withstand current (1s)		I <sub>cw</sub>	kA rms	1	1	2	2
Connecting capacity		Number of mechanical operations (according to the standards, for other values please consult)		Cycles	10000	10000	10000	10000	8000	Maximum weight		3P	Kg	1,0	1,0	1,1	1,1
						3P+N	Kg	1,2	1,2	1,3	1,3						

	A	F		T	
		45°	90°	45°	90°
3P	136	151,8	152,7	158	161,7
4P	168	177,2	184,7	190	193,7